

ASSEMBLY & INSTALLATION INSTRUCTIONS

Olympus Sconce 209110

B460

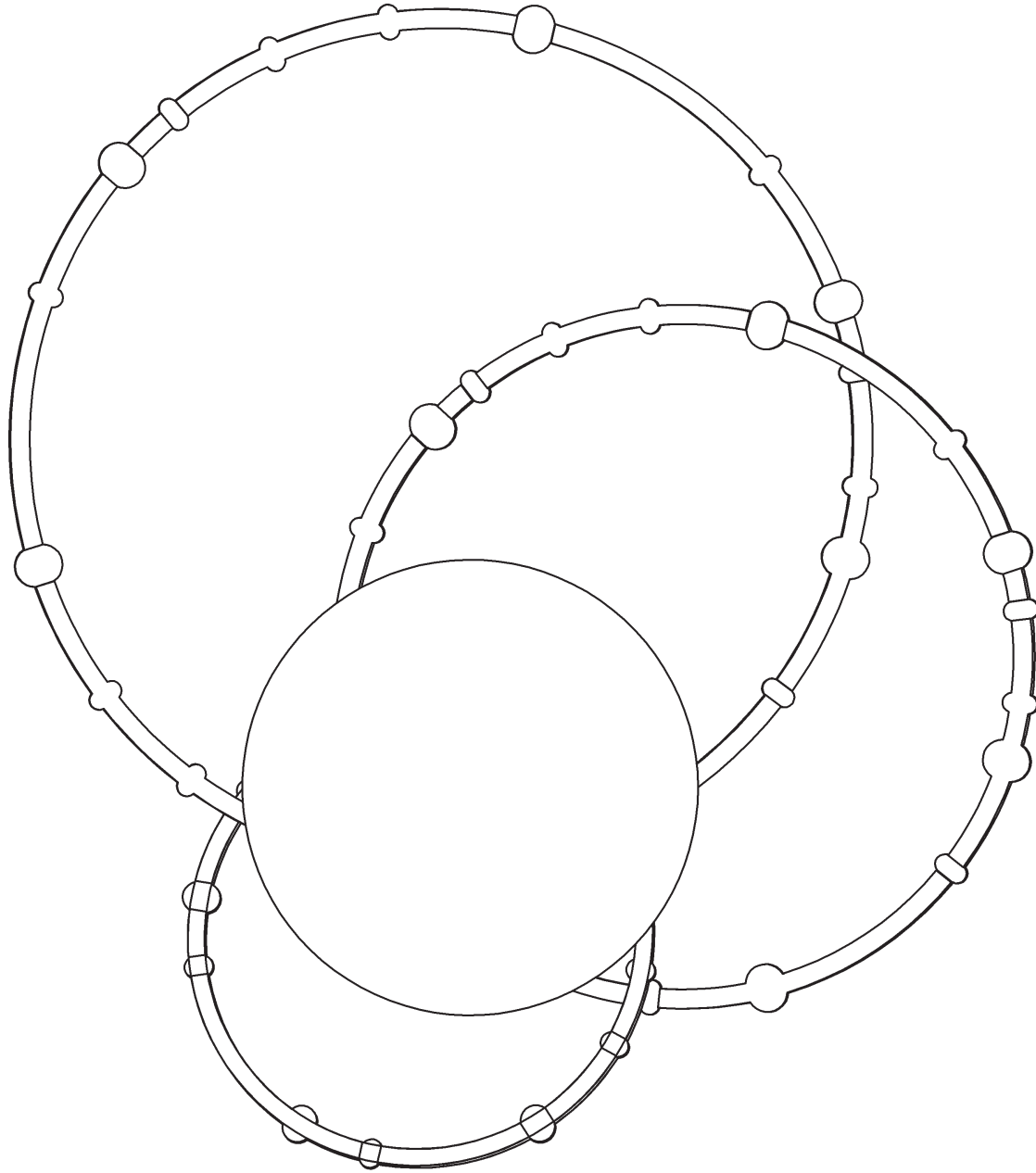

Component Parts

- A Fixture**
- B Socket Assembly**
- C Ground Screw**
- D Knuled Aluminum Ring (2)**
- E Glass**



ASSEMBLY & INSTALLATION INSTRUCTIONS

B460

Olympus Sconce 209110

CAUTION: FAILURE TO INSTALL THIS FIXTURE PROPERLY MAY RESULT IN SERIOUS PERSONAL INJURY OR DEATH AND PROPERTY DAMAGE. We recommend installation by a licensed electrician. This product must be installed in accordance with applicable installation code(s), by a person familiar with the construction and operation of the product and the hazards involved.*

Caution: Do not exceed maximum wattage noted on fixture. Use only recommended bulbs with fixture.

Please Note: After installation extra hardware and accessories are possible; our kits are used on multiple products.

To Install Fixture (Figure 1)

CAUTION: BE SURE POWER IS OFF AT THE MAIN BREAKER BOX PRIOR TO INSTALLATION.

1. Carefully unpack fixture (A) from the carton.
2. Locate socket assembly (B). While holding the socket assembly close to the electric box and using suitable wire connectors (not provided), connect fixture wires to supply (white or ribbed to white and black or smooth to black). Attach a pigtail lead to the crossbar ground screw (C).

CAUTION: MAKE SURE WIRE CONNECTORS ARE TWISTED ON SECURELY AND NO BARE WIRE IS EXPOSED.

3. Push wires into electric box and using two machine screws (not provided), fasten the socket assembly (B) to the electric box.

Note: A new electric box comes with screws. When replacing a fixture, retain the existing screws for use with the new fixture.

4. Slide fixture (A) over the socket assembly (B), while holding fixture (A) close to the wall, connect the ground wire from the fixture (A) with all other ground wires using a suitable wire connector.
5. Orient fixture (A) to desired position.
6. Thread knurled aluminum ring (D) on to socket assembly (B) to secure fixture (A). Thread the second knurled aluminum ring (D) on to the socket assembly (B).
7. Install bulb (not included)
8. Thread glass (E) onto socket assembly (B).
9. Restore electricity at main breaker.

ASSEMBLY & INSTALLATION INSTRUCTIONS

B460

Olympus Sconce 209110

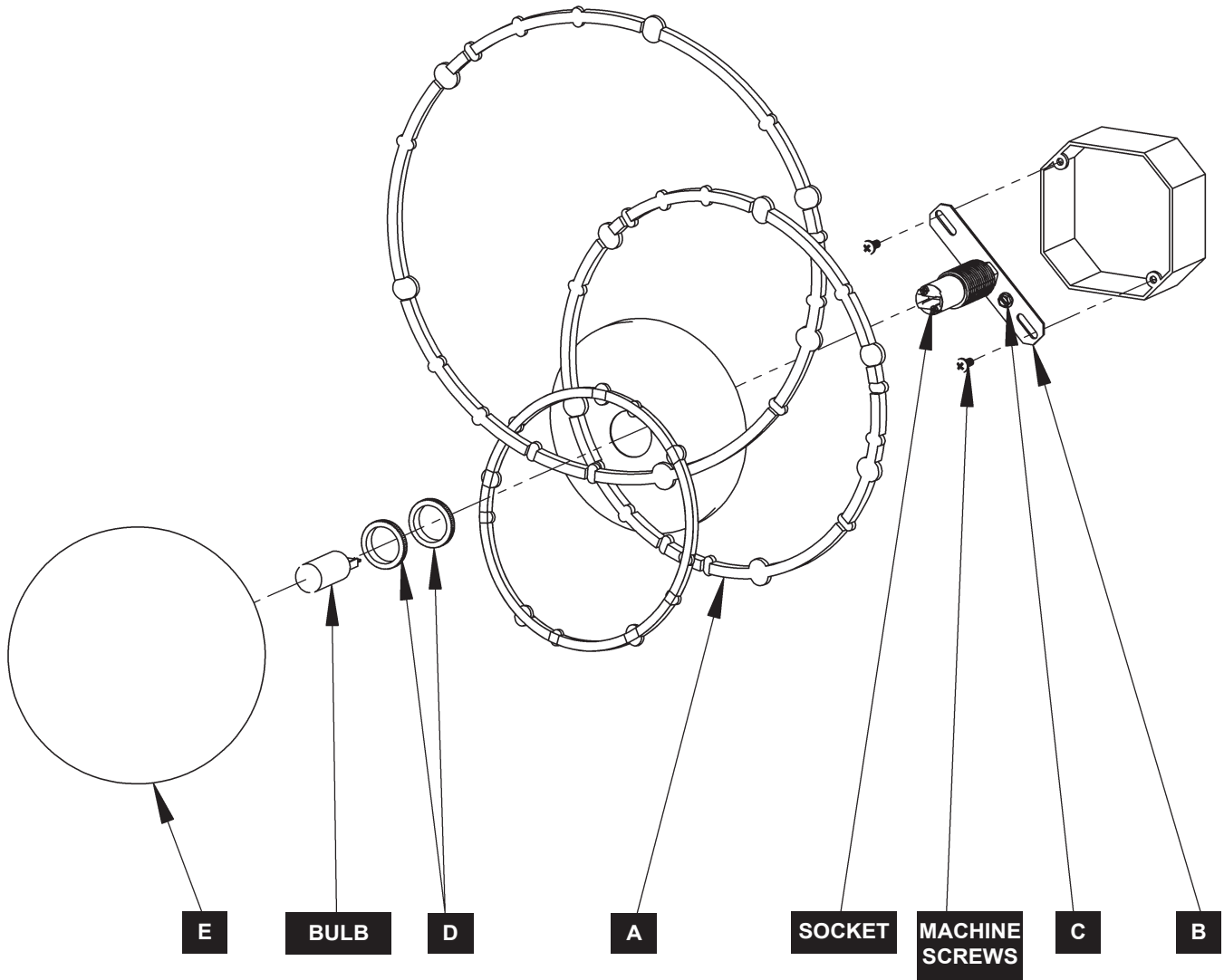

(Figure 1)

If you need further assistance, or find that you are missing any parts, please contact the dealer from which you purchased this product. We hope you enjoy your fixture!

*** Hubbardton Forge will not be liable for injury or damage caused by improper installation, lamping or use of this fixture.**